

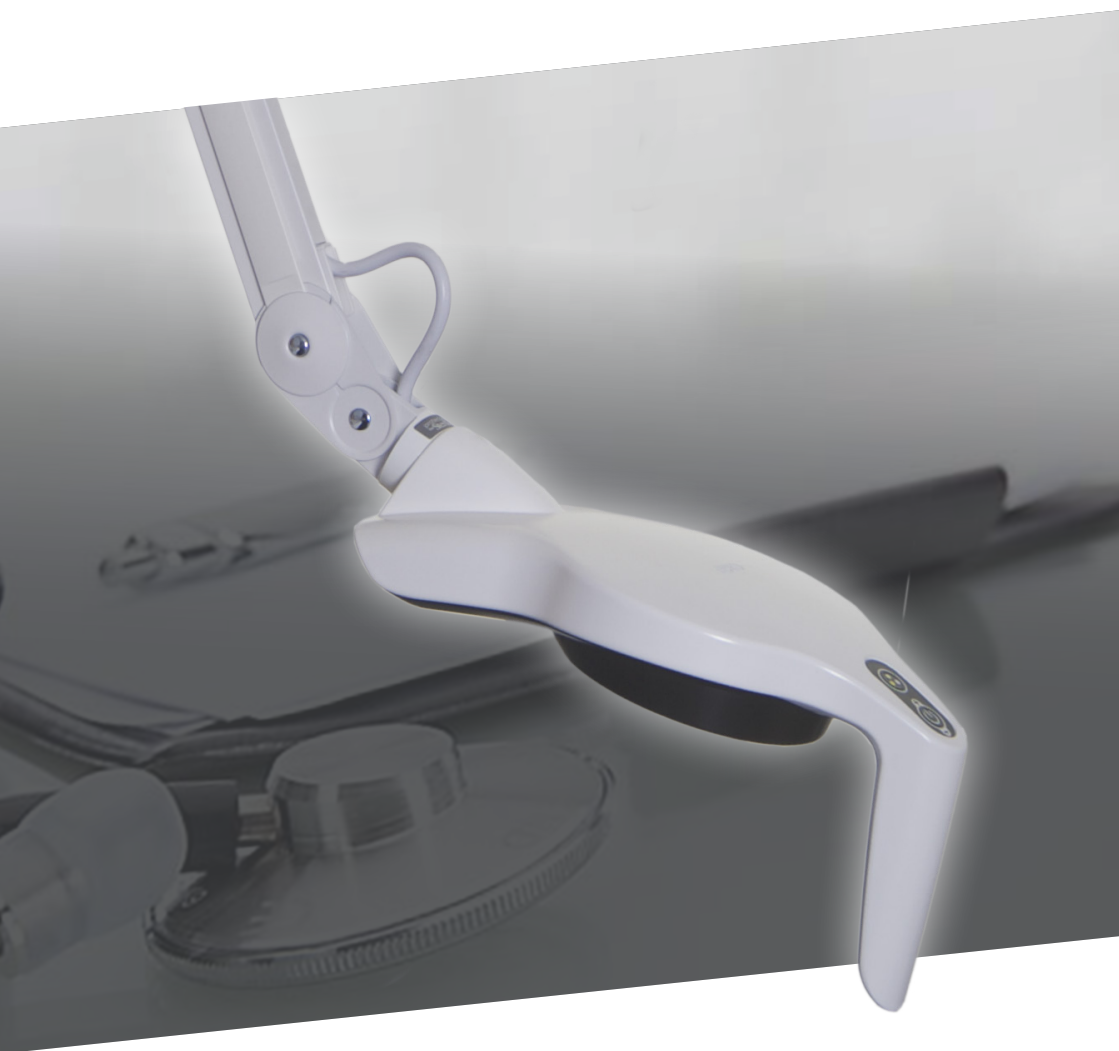

Luxo LHH G2/LHH G2 CCT

User manual

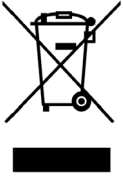



English

Our products are subject to the Directive 2012/19/EU (Waste Electrical and Electronic Equipment - WEEE) and should at the end of their lifespan always be collected separately and brought to the appropriate collection point in your community or region.

Norsk

Våre produkter er underlagt direktiv 2012/19/EU (Waste Electrical and Electronic Equipment - WEEE) og skal etter endt levetid leveres til mottak for slukt avfall eller til en forhandler av slukt avfall.

Svenska

Våra produkter omfattas av direktivet 2012/19/EU (Waste Electrical and Electronic Equipment - WEEE) och skall vid slutet av sin livsängd alltid samlas in och levereras till återvinningsstation i din kommun eller region.

Deutsch

Unsere Produkte unterliegen der Richtlinie 2012/19/EU (Waste Electrical and Electronic Equipment - WEEE) und sollten am Ende ihrer Lebensdauer immer getrennt gesammelt und an einem entsprechenden Sammelpunkt in Ihrer Gemeinde oder Region entsorgt werden.

Suomi

Tuote kuuluu elektronisten laitteiden jätteenkäsittelyä (WEEE) koskevan direktiivin 2012/19/EU piiriin ja elinkaaren lopussa oleva tuote tulee toimittaa asiaankuuluvaan keräyspisteeseen.

Eesti

Meie toodete kohta kohaldatakse 2012/19/EU WEEE (elektrija elektroonikaseadmetest tekkinud jäätmete) direktiivi ning nad peavad olema eluea lõppedes eraldi kokku kogutud ning toimetatud piirkonna jäätmete vastuvõtupunkti.

Nederlands

Onze producten zijn onderworpen aan de Richtlijn 2012/19/EU (Waste Electrical and Electronic Equipment - WEEE) en moeten aan het einde van hun levensduur apart ingezameld en naar het juiste inzamelpunt gebracht worden in uw gemeente of regio.

Dansk

Vores produkter er underlagt direktiv 2012/19/EU (Waste Electrical and Electronic Equipment - WEEE) og skal efter endt levetid leveres til modtagere for sådan type affald eller til en forhandler af sådan affald.

RISK GROUP 2

CAUTION: Possibly hazardous optical radiation emitted from this product. Do not stare at operating lamp. May be harmful to the eye.

LHH G2/LHH G2 CCT

Instructions for use in your local language, please visit www.glamox.com

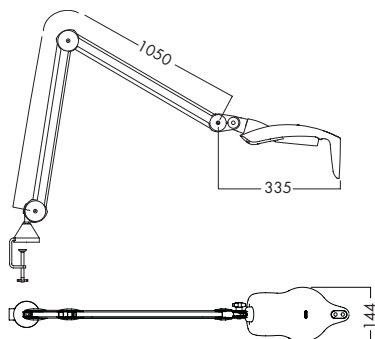

This product contains a spring loaded arm. In order to avoid damage or possible injury, first mount table bracket or floor stand. Insert product and remove protective plastic sleeve or rubber band, and carefully unfold the product.

Use only brackets supplied by Glamox or a Glamox representative. Glamox cannot guarantee the lifetime and functionality if third part accessories are used.

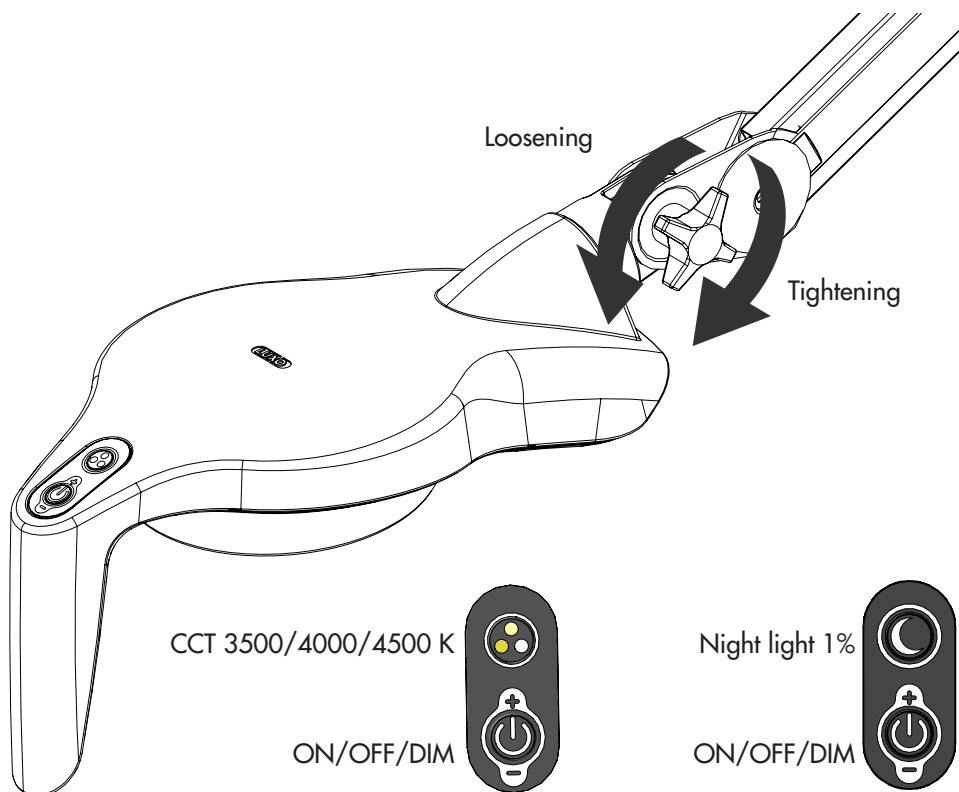

LHH G2/LHH G2 CCT

General information

This luminaire is intended for use as a general purpose examination luminaire. If the product is used during treatment there should be NO contact with the patient.

This product are not designed and approved for home use.

Optimum working distance between the light source and illuminated object or surface, using a standard lamp, is 50 cm.

Installation

This product contains a spring loaded arm. In order to avoid damage or possible injury, first mount table bracket or floor stand. Insert product and remove protective plastic sleeve or rubber band, and carefully unfold the product.

Place the supply cable so it not will be damaged.

Always use enclosed table bracket, optional floor stand or wall brackets.

For accessories available for this product, please visit our website www.glamox.com

Luxo cannot guarantee the lifetime and functionality if third party accessories are used.

Cleaning

Blow and dry off any dust and dirt.

Using of different cleaning agents for cleaning this product:

Avoid use of alcohol, acids or any kind of organic solvents (Isopropanol etc.)

Only use the weak mix of ordinary soap and water without any perfumes.

Maintenance

Cleaning of product is the only maintenance needed. No requirements on frequency of cleaning other than when the products get degraded functions on movements or light.

There are no parts requiring special inspection or maintenance on the product.

Transportation

The product should be set in transportation mode when moved. Fold upper arm down in parallel with the lower arm, and secure them together with a rubber band or strips.

Spare parts	
SPA026011	Cable 3x0.75+/3,0m BS1363A White
SPA026705	AC/DC LHH G2 class I 24V
SPA026706	Led Module LHH G2
SPA026707	Led Module CCT LHH G2
SPA026708	Cable 3x0.75+/3,0m Schuko White
SPA026709	Cable 3x18 AWG/3,0m NA White
SPA026710	Fuse T1.25AH/250V

Description to exchange spare parts will be supplied upon request to service personell

LHH G2/LHH G2 CCT

Troubleshooting for qualified electrical fitters and other similarly qualified personnel

- Replaces the fuses
 - Remove the lamp from mains supply.
 - Loosen the screw holding the bottom lamp cover
 - Exchange fuses
 - Place bottom cover, and tighten the screw
- Replaces the mains cable
 - Instruction for changing cable will be shipped with the spare part

If there should arise other problems please contact your local Glamox representative

Classification	
	LHH G2/ LHH G2 CCT
Medical class:	Class I
Permitted leakage current	
Protection reliability	Must not exceed 0.5 mA
Power supply	Resistance in earth circuit – earth connection 0.1
Power consumption	100-240VAC 50/60 Hz
Mode of operation	LHH G2 max 60VA LHH G2 CCT max 50VA
Protection against risk of explosion	Not protected
Protection against liquid penetration	Not protected
Degree of mobility	Mobile table
Type of approval	MEDICAL Standard
Safety test in line with	EN 60601-1 :2012
EMC test in line with	EN 60601-1-2 :2007
Primary fuse	IEC 127-5X20mm, 2xT1.25AH 250V
Operating life	50000 Hours (L70B50)
G2 CCT:	
Central illuminance 4500K	28500lx at 1m
Central illuminance 4000K	27900lx at 1m
Central illuminance 3500K	25900lx at 1m
G2:	
Central illuminance 3700K	35200lx at 1m

LHH G2/LHH G2 CCT

Symbol explanations:



Do not throw away. Electronic waste.
The product must be recycled



Self declaration symbol



Approved by Nemko



Attention, read instructions before use

Warning:

- Avoid spilling liquid on the lamp head
- Have minimum 400 Lux light, when reading the labels on the product
- The power cable must only be replaced by a qualified electrical fitter or other similarly qualified professional.
- The switch disengages the low voltage to the lamp only. To disconnect the mains supply, unplug the plug from the socket outlet.
- To avoid risk of electric shock, this equipment must only be connected to a supply main with protective earth.
- This ME EQUIPMENT could cause risk of reciprocal interference during specific investigations or treatments.
- Position the product so that it's easy to disconnect the device when the product is used as isolation means.
- To terminate operation, turn the product off with the switch. For storage, unplug the device and fold the arm together.
- Any repairs of the arm must be performed by Glamox or Glamox approved personnel. The arm contains high tensions springs.
- Do not modify this equipment without authorization of the manufacturer.
- This product complies to IEC/EN 60601-1-2, electromagnetic compatibility for medical devices. Electromagnetic or other interference between this equipment and other devices should not occur. In the event of interference, please move the equipments apart from each other.
- The switch disengages the low voltage to the lamp only. To disconnect the mains supply, unplug the plug from the socket outlet.
- When abnormal use Glamox declines all responsibilities regarding the product
- Users of this form of lighting should be aware that the manufacturer of the product can only accept liability for the lighting when maintenance, repairs or changes are carried out by the manufacturer or by companies which the manufacturer has approved to carry out such work, and when components that influence the safety of the lighting are replaced with original spare parts. The lighting is not intended for use in areas where there is a risk of explosion.

Disposal

Disposal the product at a special collection centre for recycling of electronic and waste.

Environmentally conditions

Transport and storage

Ambient temperature	-20° C to 70° C
Moisture content	10 % to 100 % (keep dry)
Atmospheric pressure	500hPa til 1060hPa

Operate

Ambient temperature	5° C to 40° C
Moisture content	30 % to 75 %
Atmospheric pressure	700hPa to 1060hPa, Max 3000m

Declaration of Conformity

(Directive 93/42/EEC as amended by directive 2007/47/EE
and RoHS directive 2011/65/EU, EcoDesign directive 2012/1194/EU)

Manufacturer: Glamox AS

Address: Bruksvegen 7
2260 Kirkenær
Norway

Product: Ceiling, trolley, wall and Table standing LED
luminaire for medical

Product name: **LHH G2 / LHH G2 CCT**

We declare under sole responsibility that above listed products conforms with the standards listed.

<i>Reference</i>	<i>Date of issue</i>	<i>Name</i>
EN-60601-1	2012	General requirements (lighting)
EN-60601-1-6	2010	Collateral standard: Usability
EN 60601-2-41	2009	Particular requirements for the safety of surgical luminaires and luminaires for diagnosis
EN 62366	2008	Application of usability engineering to medical devices
EN 60601-1-2	2014	Electromagnetic compability – Requirments and tests.

Place and date: Kirkenær, 20 April 2016

Name and signature of
authorized persons:

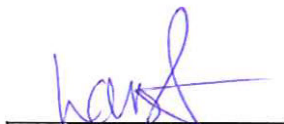
A handwritten signature in blue ink, appearing to read "Lars", written over a horizontal line.

Lars Andersson Wehlin
Factory Manager

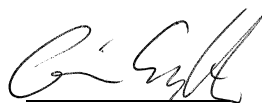
A handwritten signature in blue ink, appearing to read "Geir Sylte", written over a horizontal line.

Geir Sylte
Laboratory Manager



© Glamox February 2017 Item no: 05-900-713-00 Doc. no: BRU-303-0112 Rev. no. 1

Manufactured by:

Glamox AS, BU Luxo production Kirkenær
Industrifellet, 2260 Kirkenær
TEL. (47) 22 02 11 00, FAX (47) 22 02 11 02

Please visit our web site for contact information
www.glamox.com



Please refer to our website
for information about
our 5-year warranty.